

N

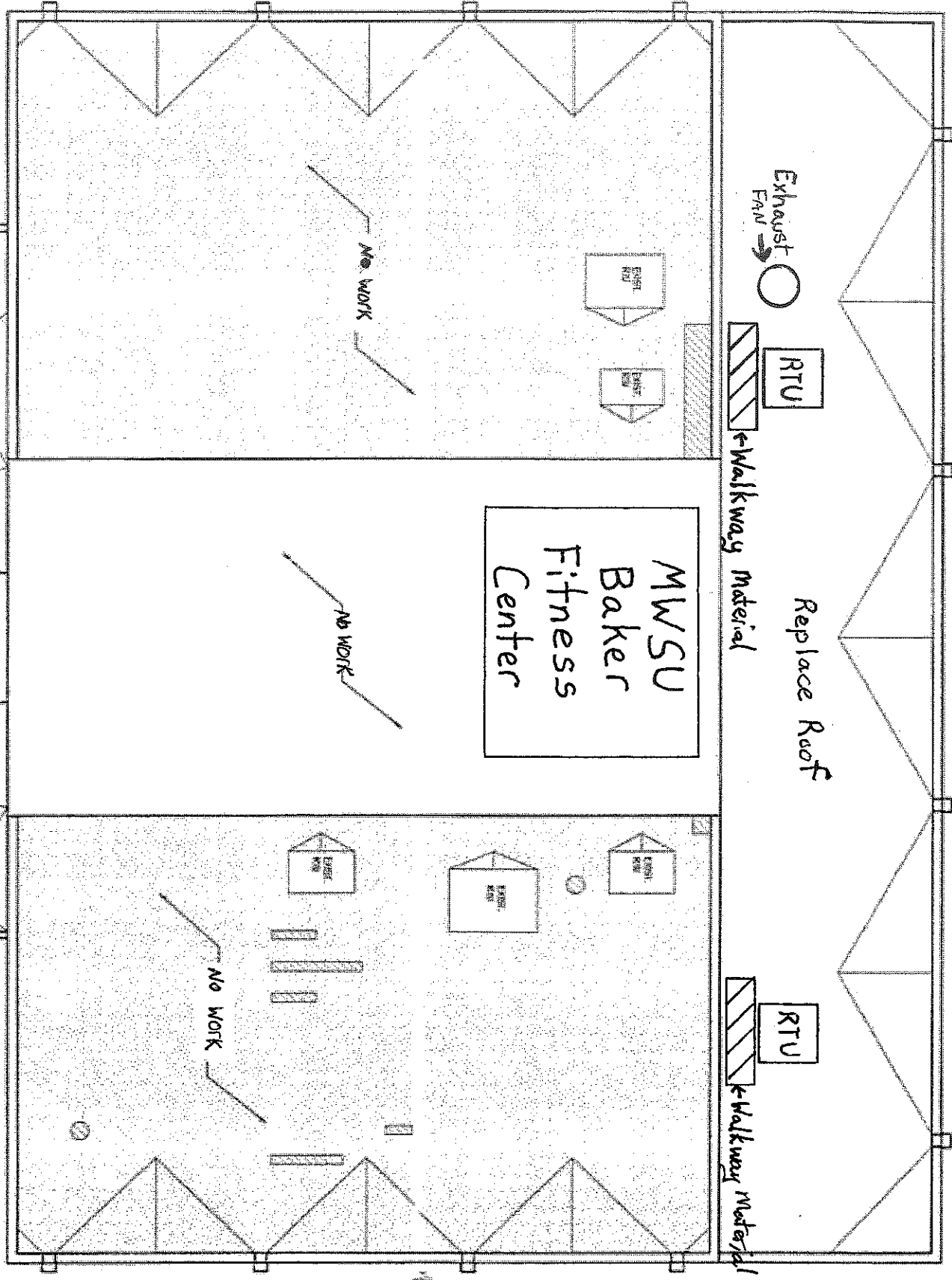

Exhaust FAN

RTU

Walkway Material

Replace Roof

RTU

Walkway Material

MWSU Baker Fitness Center

No Work

No Work

No Work

West Canopy

Replace Roof

No Work

East Canopy

1. DESIGN IS BASED ON PROVIDED INFORMATION - SUBJECT TO FIELD VERIFICATION
2. DESIGN UTILIZES A 0.5" MINIMUM TAPER START - CONTRACTOR TO DETERMINE IF BASE LAYER IS REQUIRED
3. DESIGN UTILIZES A 1/8" TAPER SLOPE & 1/2" CRICKET SLOPE
4. FLAT INSULATION IS REQUIRED FOR SLOPED DECKS - NOT INCLUDED IN DESIGN
5. DESIGN INCLUDES MATERIAL TO FIELD FABRICATE (8) 4X4" TAPERED SUMPS (0.5"-1.5")
6. UNIT CRICKETS & OVERLAY BOARDS ARE TO BE BY CONTRACTOR

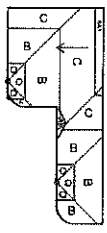
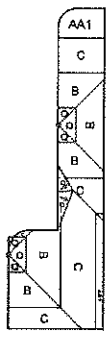
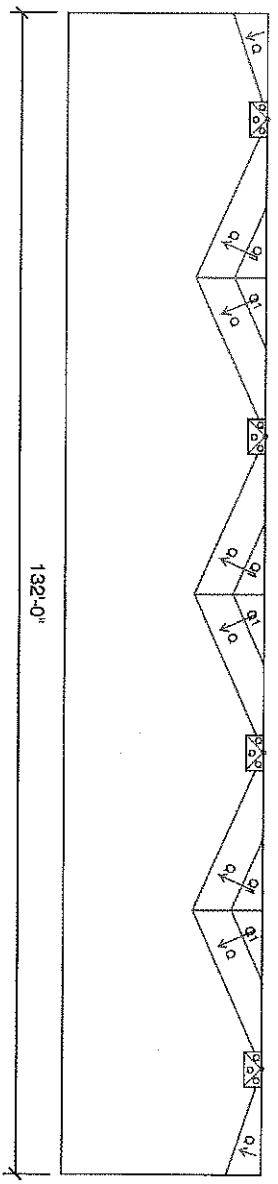

QUOTED PRICE IS ONLY GOOD THRU STATED DATE BELOW AND WILL BE INVOICED WITH CURRENT PRICING AT TIME OF DELIVERY - NOT TO SCALE - FOR BIDDING PURPOSES ONLY

TAPERED SYSTEM PROPERTIES

TAPERED PANELS: INSULBASE POLYISO 20 PSI
 FILL PANELS: INSULBASE POLYISO 20 PSI
 CRICKET PANELS: INSULBASE POLYISO 20 PSI
 FILL PANELS: INSULBASE POLYISO 20 PSI

TAPERED SPECS
 MIN. THICKNESS: 0.5"
 MAX. THICKNESS: 2.9"
 SLOPE (60/10): 1/2", 1/8"

CRICKET SPECS
 MIN. THICKNESS: 0.5"
 MAX. THICKNESS: 4.2"
 SLOPE (60/10): 1/2"

R-VALUE PER INCH: 5.7
 MINIMUM R-VALUE: 2.9
 AVERAGE R-VALUE: 11.60

TOTAL SQUARES OF APPLICATION: 12

TAPER ROOF SQ/FT: 482
 FLAT ROOF SQ/FT: N/A
 TAPER SQUARES: 5
 FLAT SQUARES: N/A
 CRICKET SQUARES: 5
 TOTAL BUNDLES: 4.55
 FILL SQUARES: 2
 TOTAL STACKS: 0
 BASE LAYER: 0
 TOTAL TRUCKS: 0.09
 CONTRACTOR PRICE

ALL MATERIAL IS F.T.C. UNLESS OTHERWISE NOTED
 *PRICE IS FOR MATERIAL ONLY & DOES NOT INCLUDE ANY RESIDENT OR FUEL SURCHARGES.
 *ADDITIONAL RESIDENT WILL BE APPLIED IF TRUCKS CANNOT BE FILLED OUT.

PROJECT

Baker Family Fitness Center
 St. Joseph, Missouri

PRICING VALID THRU **03/31/26**
 PROJECT NUMBER **108656A02**

DATE: 01/22/2026
 DESIGNER: Stephen Treadwell

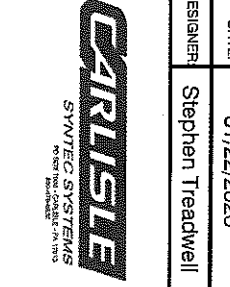

SECTION 03500 - CEMENTITIOUS WOOD FIBER DECK

PART 1 - GENERAL

1.1 SECTION REQUIREMENTS

- A. Roof areas and details of applications of items specified for the entire addition to the Fitness Center
- B. Refer to ROOFING AND INSULATION and STRUCTURAL STEEL AND MISCELLANEOUS METAL sections of the specifications for applicable provisions relating to this installation.
- C. Installation shall be accomplished by a factory approved erector who has 5 years experience installing lightweight insulating concrete in accordance with the manufacturer's instructions.
- D. Submit to Architect for approval detailed shop drawings indicating complete layout and details relative to installation of deck and any connection to adjacent construction.

PART 2 - PRODUCTS

2.1 MATERIALS

- A. Roof deck shall be Tectum III as manufactured by Tectum, Inc., Newark, Ohio. Panel size shall be 5" precast slabs of treated wood fibers and Magnewium Oxysulphate cement binding agents producing a rigid plank and providing the following physical characteristics;

1. weight	Max. 5.0 lbs/sf.
2. R-value thermal insulation	19
3. Noise Reduction Coefficient	Max. .60
4. Non-comustible	
5. Have silicone treatment applied to face of material	
6. Light reflectance	Min. 60%

- B. Tectum III to be made of 1 1/2" T & G Tectum, 3" Styrofoam and 1/2" waferboard sheathing.

PART 3 - EXECUTION

3.1 INSTALLATION

- A. Tectum III shall be screwed and glued to steel joist per ICBO Report 1116. Screws shall be 1" longer than thickness of decking and a 1 1/2" washer shall be used with each screw.
- B. All ends and edges of decking must be continuously supported along the outside walls directly on by supplemental framing.
- C. Tectum planks shall be cut to fit neatly at walls, parapets, curls, or other openings greater than 8" in either direction must have additional structural frame support.

3.2 SHOP DRAWINGS AND APPROVALS

- A. Submit to architect for approval detailed shop drawings indicating complete layout and details relative to installation of deck and any connections to adjacent construction.