

**ELLISON-AUXIER
ARCHITECTS INC.**
924 FRANCIS ST. JOSEPH, MO 64501 (816) 233-8003 FAX 233-7793

PROJECT: PROPOSED RENOVATIONS
STUDENT UNION
MISSOURI WESTERN STATE COLLEGE
4525 DOWNS DRIVE
SAINT JOSEPH, MISSOURI

SHEET: M12
OF: 12
DATE: 12-8-98

FLOOR PLAN NOTES:

1. PLUMBING CONTRACTOR TO REMOVE THIS EXISTING FLOOR DRAIN AND ALL ASSOCIATED WASTE AND VENT PIPING. CAP AIR TIGHT WHERE SHOWN ON DRAWING.
2. CONNECT NEW HW AND CW PIPING REQUIRED TO EXISTING HW AND CW IN WALL.
3. REMOVE EXISTING FLOOR DRAIN. MODIFY WASTE AND VENT AS REQUIRED. PROVIDE AND INSTALL NEW FLOOR SINK.
4. CONNECT TO EXISTING GAS PIPING IN WALL. MODIFY AS REQUIRED.
5. REMOVE EXISTING FIXTURE. CONNECT NEW FIXTURE MODIFY WASTE, VENT, CW, AND HW AS REQUIRED.
6. SEE SHEET M13 FOR CONTINUATION OF THIS STEAM PIPING.
7. BUCKET TRAP REQUIRED. SEE DETAIL IN SHEET M15.

GENERAL NOTES:

1. PLUMBING CONTRACTOR TO SEE SHEET FSE-14 FOR FOOD SERVICE EQUIPMENT PLUMBING SCHEDULE.
2. PLUMBING CONTRACTOR TO COORDINATE ALL CUTTING, REMOVAL AND PATCHING WITH GENERAL CONTRACTOR.

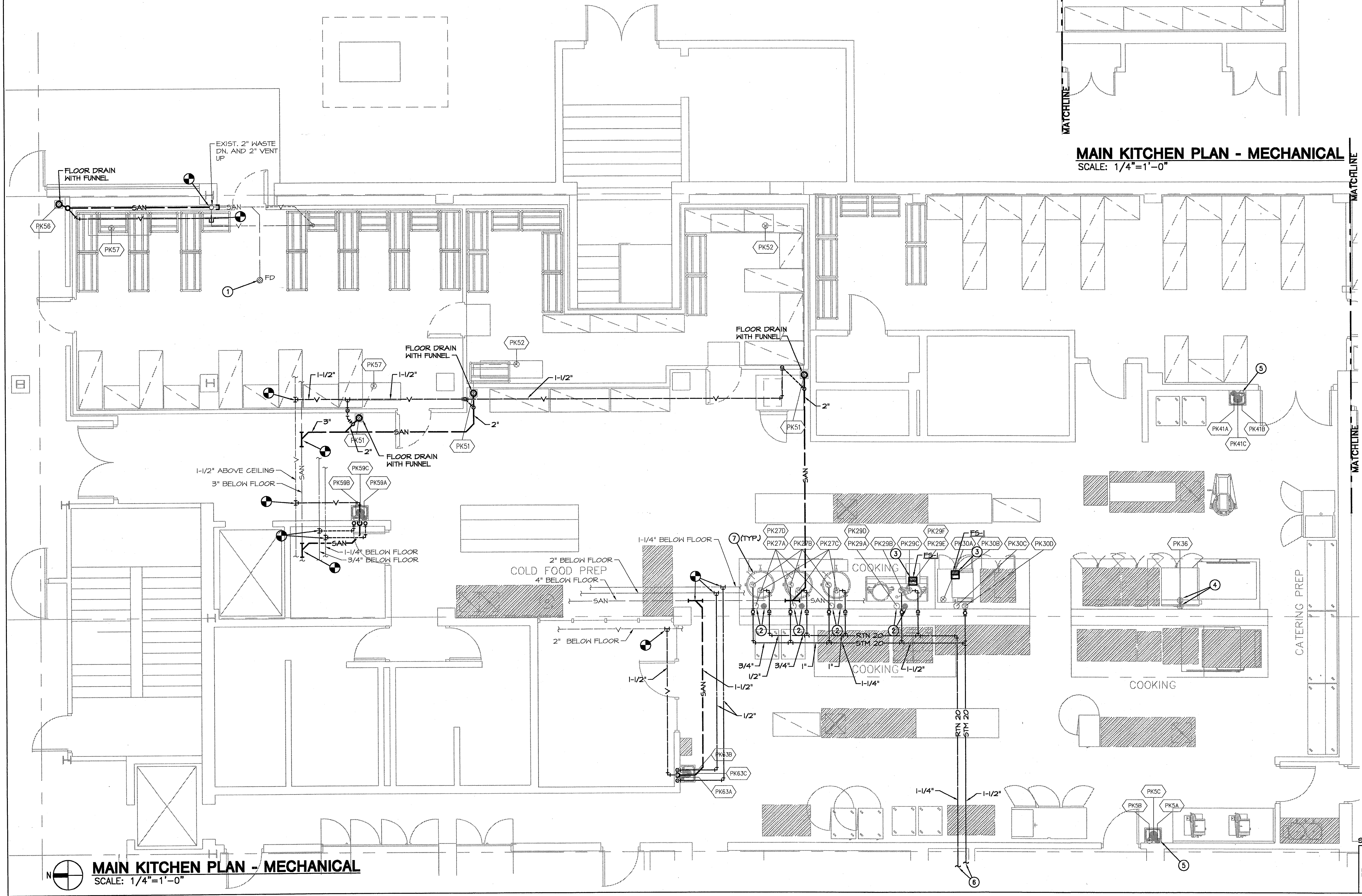

MAIN KITCHEN PLAN - MECHANICAL
SCALE: 1/4"=1'-0"

PROJECT NAME: MWC STUDENT UNION
PROJECT NUMBER: 8621902
DATE: 12/12/98
DRAWN BY: JAW
CHECKED BY: JAW
DATE: 10-18-98

MAIN KITCHEN PLAN - MECHANICAL
SCALE: 1/4"=1'-0"

54B #4821902
SMITH & BOUCHER, INC.
CONSULTING ENGINEERS
8620 WEST 110TH STREET
OVERLAND PARK, KANSAS 66210
(913) 346-2127
SMITH & BOUCHER, INC.
(913) 345-0617 (FAX)