



ELLISON - AUXIER
ARCHITECTS

Addendum No. 2

Date: 11.11.2022

Project: Missouri Western State University – Cross Country Building – FB23-054

All Prospective Bidders:

All bidders furnishing necessary materials and/or labor, this addendum is hereby part of the Contract Documents as though it were originally therein. Refer to Proposal Form for acknowledgement of Addenda.

Clarification:

1. General Contractors are to contact Chad Wunsch,
Email: chad.wunsch@tmi-stl.com | tmi-stl.com
Mobile: (636) 484-6533 | Main: (636) 532-1110
for the HVAC scope of work price to be included in the base bid. Price will include material and installation.
2. Soffit panel material may be LP Smart side Series 76 soffit panels.

Changes to Drawings:

CIVIL

1. **Sheet 10**
 - a. See attached revised sheet for electrical service information.

End of Addendum

P:\Projects\2021\122.0727.11 - Utilities - MWSU Cross Country Building - 122.0727.11 - Utilities.dwg RYAN SNEYDER, UTILITIES, 2021/11/01 4:42 PM, ANSI FULL BLEED (0.34, 0.34, 23.00, 23.00) INCHES

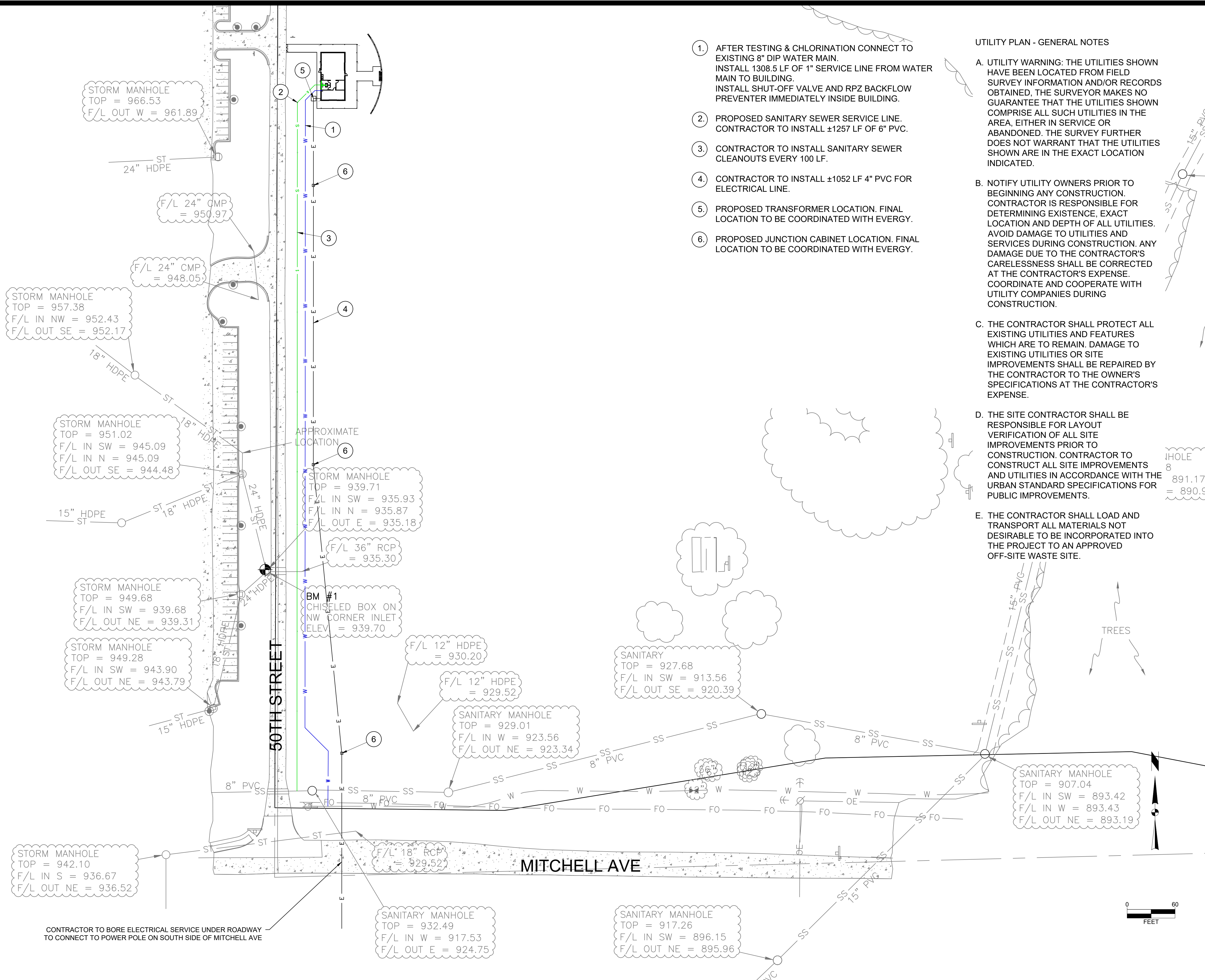

1. AFTER TESTING & CHLORINATION CONNECT TO EXISTING 8" DIP WATER MAIN. INSTALL 1308.5 LF OF 1" SERVICE LINE FROM WATER MAIN TO BUILDING. INSTALL SHUT-OFF VALVE AND RPZ BACKFLOW PREVENTER IMMEDIATELY INSIDE BUILDING.
2. PROPOSED SANITARY SEWER SERVICE LINE. CONTRACTOR TO INSTALL ±1257 LF OF 6" PVC.
3. CONTRACTOR TO INSTALL SANITARY SEWER CLEANOUTS EVERY 100 LF.
4. CONTRACTOR TO INSTALL ±1052 LF 4" PVC FOR ELECTRICAL LINE.
5. PROPOSED TRANSFORMER LOCATION. FINAL LOCATION TO BE COORDINATED WITH EVERGY.
6. PROPOSED JUNCTION CABINET LOCATION. FINAL LOCATION TO BE COORDINATED WITH EVERGY.

UTILITY PLAN - GENERAL NOTES

- A. UTILITY WARNING: THE UTILITIES SHOWN HAVE BEEN LOCATED FROM FIELD SURVEY INFORMATION AND/OR RECORDS OBTAINED. THE SURVEYOR MAKES NO GUARANTEE THAT THE UTILITIES SHOWN COMPRISE ALL SUCH UTILITIES IN THE AREA, EITHER IN SERVICE OR ABANDONED. THE SURVEY FURTHER DOES NOT WARRANT THAT THE UTILITIES SHOWN ARE IN THE EXACT LOCATION INDICATED.
- B. NOTIFY UTILITY OWNERS PRIOR TO BEGINNING ANY CONSTRUCTION. CONTRACTOR IS RESPONSIBLE FOR DETERMINING EXISTENCE, EXACT LOCATION AND DEPTH OF ALL UTILITIES. AVOID DAMAGE TO UTILITIES AND SERVICES DURING CONSTRUCTION. ANY DAMAGE DUE TO THE CONTRACTOR'S CARELESSNESS SHALL BE CORRECTED AT THE CONTRACTOR'S EXPENSE. COORDINATE AND COOPERATE WITH UTILITY COMPANIES DURING CONSTRUCTION.
- C. THE CONTRACTOR SHALL PROTECT ALL EXISTING UTILITIES AND FEATURES WHICH ARE TO REMAIN. DAMAGE TO EXISTING UTILITIES OR SITE IMPROVEMENTS SHALL BE REPAIRED BY THE CONTRACTOR TO THE OWNER'S SPECIFICATIONS AT THE CONTRACTOR'S EXPENSE.
- D. THE SITE CONTRACTOR SHALL BE RESPONSIBLE FOR LAYOUT VERIFICATION OF ALL SITE IMPROVEMENTS PRIOR TO CONSTRUCTION. CONTRACTOR TO CONSTRUCT ALL SITE IMPROVEMENTS AND UTILITIES IN ACCORDANCE WITH THE URBAN STANDARD SPECIFICATIONS FOR PUBLIC IMPROVEMENTS.
- E. THE CONTRACTOR SHALL LOAD AND TRANSPORT ALL MATERIALS NOT DESIRABLE TO BE INCORPORATED INTO THE PROJECT TO AN APPROVED OFF-SITE WASTE SITE.

HOLE
8
891.17
= 890.94

CONTRACTOR TO BORE ELECTRICAL SERVICE UNDER ROADWAY TO CONNECT TO POWER POLE ON SOUTH SIDE OF MITCHELL AVE

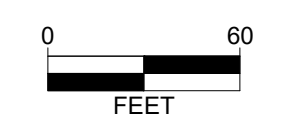

MARK	REVISION	DATE	BY
Engineer: RS	Checked By: SD	Scale: 1" = 60'	
Technician: JS	Date: 07-01-2022	T-R-S:	

STATE OF MISSOURI
SHAWN DUKE
NUMBER
PE-2013006489
PROFESSIONAL ENGINEER
SHAWN DUKE - ENGINEER
MO PE#2013006489

MWSU CROSS COUNTRY BUILDING
UTILITIES
ST. JOSEPH, MISSOURI
SNYDER & ASSOCIATES
ENGINEERS & PLANNERS, INC.
802 FRANCIS STREET
ST. JOSEPH, MISSOURI 64501
816-364-5222 | www.snyder-associates.com

SNYDER & ASSOCIATES